

# SharpShooter



**HVLP PAINT SPRAY SYSTEM**



## User's Manual

**SharpShooter  
SS-100**

### **Smith Eastern Corporation**

10630-S Riggs Hill Road • Jessup, Maryland 20794-9425 USA  
301.497.7600 • 800.937.HVLP (4857) • Fax 301.497.7613  
info@airverter.com • www.airverter.com

**Compliance • Quality • Performance • Reliability**

# **AirVerter<sup>®</sup> SharpShooter HVLP Paint Spray System**

**DO NOT OPERATE SPRAY GUNS WITHOUT PERSONAL SAFETY EQUIPMENT**

**Please Read This Owner's Manual *BEFORE*  
Using Your SharpShooter Spray Gun**

**DO NOT OPERATE THIS EQUIPMENT WITHOUT USING PROPER PERSONAL SAFETY EQUIPMENT INCLUDING RESPIRATOR, GOGGLES AND SAFETY CLOTHING. OBSERVE ALL PRECAUTIONS RELATED TO SPRAYING.**

***WARNING***

**THIS EQUIPMENT IS OPERATED USING PRESSURIZED AIR. ALWAYS DISCONNECT SPRAY GUN FROM AIR AND FLUID HOSES AND DEPRESSURIZE SYSTEM PRIOR TO ANY MAINTENANCE OR DISASSEMBLY PROCEDURE.**

**WARRANTY**

Smith Eastern Corporation warrants to the Purchaser that the SharpShooter (SS-100) Spray Gun is free from defects in material or workmanship under normal use and service for a period of twelve (12) months from the date of purchase. Should any failure appear during this period, Smith Eastern shall, if given prompt written notice by the Purchaser, correct such nonconformity by repair or replacement of the nonconforming part, F.O.B. Smith Eastern's repair facility. Repair parts are warranted for ninety (90) days from the date of shipment, but repairs or replacements to original equipment shall not renew or extend the warranty period of such equipment. Equipment and parts furnished by Smith Eastern but manufactured by others shall be limited to the warranty offered by the manufacturer thereof.

Smith Eastern reserves the right to limit this warranty in cases of misuse or abuse. Any modifications to spray guns or recommended procedures will void the warranty.

The foregoing warranty is exclusive and in lieu of other warranties of quality or performance, expressed, implied or statutory, including any warranties of merchantability or of fitness for a particular purpose.

# AirVerter<sup>®</sup> SharpShooter HVLP Paint Spray System

## EQUIPMENT REQUIREMENTS

### Air Compressor

Air compressors used with AirVerter<sup>®</sup> Spray Guns must be able to HOLD a minimum of 40 PSI while spraying. **Note:** Position a pressure gauge in the air hose nearest the spray gun to be assured of the PSI required to satisfactorily spray your coating.

### High Pressure Air Hose

- A. Air hose lengths up to 50 feet **MUST** have an I.D. of 3/8" including fittings.
- B. Air hose lengths greater than 50 feet **MUST** have an I.D. of 1/2" including fittings.

## OPERATING INSTRUCTIONS

### OPERATION:

#### Starting:

- A. The SharpShooter (SS-100) Spray Gun operates with the trigger controlling both the fluid flow and airflow.

#### Before Spraying

- A. Follow the *Air and Paint Management Guidelines* listed on the following page.
- B. Before paint is poured into the cup, **make certain paint is properly mixed**. This is particularly true when mixing multi-component paints. Use a paint shaker, rotary mixer, or paint paddle to achieve a homogeneous mixture. (*Hint:* Split your paint into two parts; the top will be lighter and the bottom will be heavier. Completely stir the bottom half of the paint and slowly add small amounts of the top half into the heavier bottom.)
- C. **Strain your paint to remove impurities**. Use a cone strainer or a 100-mesh nylon bag or equivalent strainer.
- D. **Thin your paint** according to the manufacturer's specifications.
- E. **Ensure needle packings are properly adjusted**. Needle packings are preset at the factory to proper tension. However, use and cleaning may alter this setting. To adjust needle packings to proper tension:

1. With gun disconnected from air and fluid sources, pull trigger to move the needle out of the nozzle.
2. Adjust packing nut until needle is held in the open position by tension from the needle packings.
3. Loosen packing nut approximately ¼ turn or until needle returns to closed position.

#### Spraying

- A. A siphon action draws paint from the paint container into the fluid chamber of the gun and out through the nozzle where the flow of atomizing air breaks the paint stream into tiny particles, creating the spray.
  1. Needle position controls the amount of paint flowing through the fluid nozzle.
  2. Trigger action controls needle position.
  3. The Fluid Control Knob (CT-05-1) at the rear of the spray gun controls trigger action. Turning the knob to the right reduces the fluid flow, turning it to the left increases the flow.
- B. If you are having problems with the operation of your paint gun, check the Trouble Shooting Guide at the end of the manual for possible causes and solutions.

**DO NOT OPERATE SPRAY GUNS WITHOUT PERSONAL SAFETY EQUIPMENT**

# AirVerter® SharpShooter HVLP Paint Spray System

## Air and Paint Management Guidelines

| Approximate PSI   | Application   |
|---|---|
| Thin Coatings<br>ZAHN #2 Test: 16 to 22 seconds<br>Minimum 40 PSI compressor pressure | Machines and implements, small parts, plant maintenance, controlled production work, work in enclosed areas with poor ventilation, priming. |

### WARNING

**Gun must be de-pressurized prior to any maintenance or disassembly procedure. Disconnect air hose prior to performing any maintenance operation.**

### Cleaning the SharpShooter Spray Gun

#### Cleaning and Gun Care

- A. Remove the Air Cap and Ring and clean with solvent.
- B. Flush gun thoroughly with solvent.

- C. Clean nozzle with brush. Never place the whole gun in solvent.
- D. Clogged holes should never be cleaned with hard objects as the smallest amount of damage may badly influence the spray pattern.
- E. Packing must be slightly lubricated after cleaning of gun.

### Spray Gun Performance Is Directly Related To How Well The Gun Is Cleaned After Use

#### Lubricate

- A. Use Vaseline or a non-silicone grease to lubricate the gun.
- B. Lubricate all threaded connections for ease of maintenance.
- C. Lubricate the Needle only where it passes through the needle packings.
- D. **DO NOT** allow lubricant to get into the Fluid Tube, Nozzle, Air Cap, or interior of the paint chamber (areas where paint may come in contact with lubricant).

**DO NOT OPERATE SPRAY GUNS WITHOUT PERSONAL SAFETY EQUIPMENT**

# AirVerter® SharpShooter HVLP Paint Spray System



**DO NOT OPERATE SPRAY GUNS WITHOUT PERSONAL SAFETY EQUIPMENT**

AirVerter® SharpShooter HVLP Paint Spray System

SharpShooter Illustrated Parts Breakdown

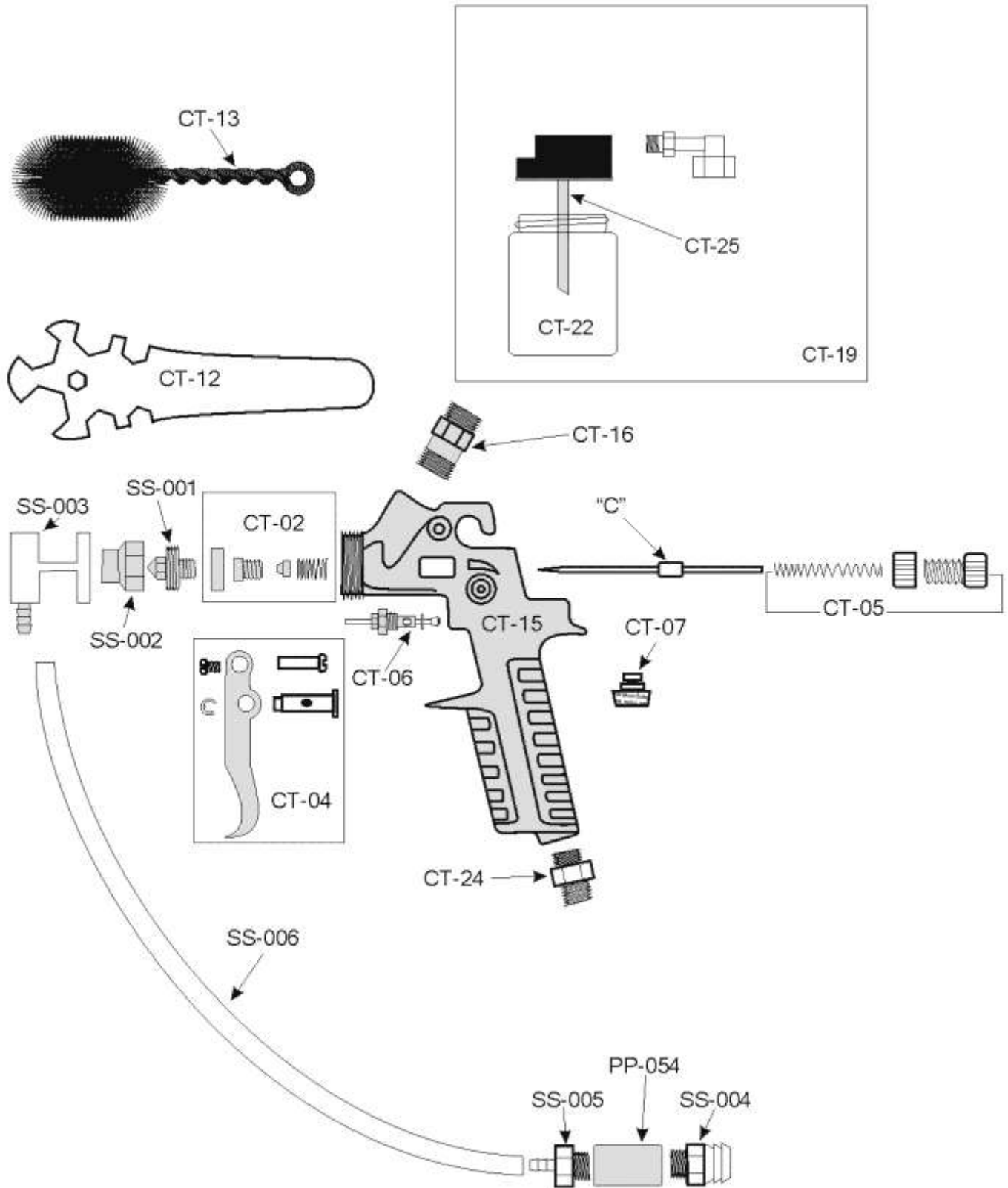

## AirVerter® SharpShooter HVLP Paint Spray System

### SharpShooter (SS-100) Parts List

| Part #   | NSN              | Description                         |
|----------|------------------|-------------------------------------|
| CT-02    | 4940-01-439-7965 | Packing Set                         |
| CT-04    | 4940-01-439-8993 | Trigger Assembly                    |
| CT-05    | 4820-01-439-8979 | Fluid Control Assembly              |
| CT-06    | 4940-01-439-9934 | Air Control Assembly                |
| CT-07    | 4940-01-439-9935 | Pattern Control Assembly            |
| CT-12    | 4940-01-439-9002 | Wrench                              |
| CT-13    | 4940-01-439-8999 | Brush                               |
| CT-14    | 4940-01-439-8998 | O-Ring                              |
| CT-15    | 4940-01-439-8327 | Body                                |
| CT-16    | 4730-01-439-8995 | Adapter Connector                   |
| CT-17-05 | 4940-01-439-8321 | Needle 0.5mm                        |
| CT-20    | 4940-01-439-7968 | Stencil Brush Attachment Kit        |
| CT-21    | 4940-01-439-9008 | Stencil Brush Jar Cover Assembly    |
| CT-22    | 4940-01-439-7037 | 22cc Jar                            |
| CT-23    | 4940-01-439-7045 | 60cc Jar                            |
| CT-24    | 4730-01-439-9007 | Air Connector                       |
| CT-25    | 4710-01-439-9006 | Suction Tube                        |
| PP-054   | 4460-01-467-6827 | Coupling                            |
| SS-001   |                  | Fluid Nozzle                        |
| SS-002   |                  | Air Cap                             |
| SS-003   |                  | Containment cage                    |
| SS-004   |                  | Barb Fitting 1 1/4" Hose – 3/4" NPT |
| SS-005   |                  | Barb Fitting 3/8" Tube – 3/4" NPT   |
| SS-006   |                  | Vacuum Hose                         |

**DO NOT OPERATE SPRAY GUNS WITHOUT PERSONAL SAFETY EQUIPMENT**



## SharpShooter Troubleshooting Guide

| Trouble   | Probable Cause  | Remedy   |
|---|---|--|
| Paint Will Not Flow                             | <ol style="list-style-type: none"> <li>1. Blockage in fluid nozzle</li> <li>2. Loose fluid nozzle</li> <li>3. Coating is too thick</li> <li>4. Loose needle packing</li> </ol>  | <ol style="list-style-type: none"> <li>1. Clean or replace; strain paint</li> <li>2. Tighten</li> <li>3. Thin the coating</li> <li>4. Adjust packing</li> </ol>  |
| Inconsistent Spray Pattern (Spits and Sputters) | <ol style="list-style-type: none"> <li>1. Running out of paint</li> <li>2. Loose needle packing</li> </ol>  | <ol style="list-style-type: none"> <li>1. Fill cup or pot, but never the top ¼</li> <li>2. Adjust packing</li> </ol>   |
| Leakage at Front of Gun                         | <ol style="list-style-type: none"> <li>1. Damaged fluid needle</li> <li>2. Wrong size fluid needle</li> <li>3. Dirty fluid nozzle</li> <li>4. Impurities in paint</li> <li>5. Loose fluid nozzle</li> <li>6. Fluid adjustment screwed all the way out</li> <li>7. Needle not firmly seated in the nozzle</li> <li>8. Packing too tight</li> </ol> | <ol style="list-style-type: none"> <li>1. Replace</li> <li>2. Replace</li> <li>3. Clean</li> <li>4. Strain paint</li> <li>5. Tighten</li> <li>6. Rotate Fluid Control Knob (CT-05-1) on rear of gun clockwise</li> <li>7. Check for nozzle obstruction</li> <li>8. Loosen and adjust to correct tension</li> </ol> |
| Distorted Spray Pattern                         | <ol style="list-style-type: none"> <li>1. Dirty or damaged air cap</li> <li>2. Dirty or damaged fluid nozzle or needle</li> <li>3. Fluid nozzle partially clogged</li> <li>4. Fluid nozzle not centered with air cap</li> <li>5. Air cap not seated correctly</li> </ol>  | <ol style="list-style-type: none"> <li>1. Clean or replace</li> <li>2. Clean or replace</li> <li>3. Clean</li> <li>4. Replace air cap</li> <li>5. Re-seat air cap</li> </ol>   |

**AirVerter® SharpShooter HVLP Paint Spray System**

**CT-11 High Wear Kit For Stencil Pro and SharpShooter Spray Guns**

**NSN 4940-01-439-7966**

| <b>Part #</b> | <b>NSN</b>       | <b>Description</b>      | <b>QTY</b> |
|---------------|------------------|-------------------------|------------|
| CT-02-3       | 4940-01-439-9946 | Teflon Seal             | 1          |
| CT-02-4       | 4940-01-439-9942 | Spring                  | 1          |
| CT-04-5       | 4940-01-439-8983 | E Ring                  | 1          |
| CT-05-3       | 4940-01-439-9930 | Spring for Paint Needle | 1          |
| CT-06-1       |                  | Spring (Air Control)    | 1          |
| CT-06-4       |                  | P. C. Seal              | 1          |
| CT-06-5       |                  | Foamed Rubber           | 1          |
| CT-07-5       |                  | Washer                  | 1          |
| CT-14         | 4940-01-439-8998 | O-Ring                  | 1          |
| CT-26-3       |                  | E Ring                  | 1          |

**DO NOT OPERATE SPRAY GUNS WITHOUT PERSONAL SAFETY EQUIPMENT**

# AirVerter<sup>®</sup> Stencil Pro HVLP Paint Spray System

**DO NOT OPERATE SPRAY GUNS WITHOUT PERSONAL SAFETY EQUIPMENT**



***AirVerte***®